

## MEDIDAS DE POLEAS MULTIVIAS

Código	Ø A	Ø B	Ø C	D	E	F	Vias	Chavetero	Obs.
M0100	72,5	49,0	17,00	31,50	66,5	5,0	7		Alt. fondo: 10,5mm
M0100R	72,5	49,0	17,00	31,50	66,5	5,0	7		Alt. fondo: 14,5mm
M0101	64,0/65,0	42,0	17,00	42,50	59,0	23,2	5		
M0102	65,0/66,0	45,0	17,00	34,00	60,0	15,0	5		
M0103	63,5	37,0	17,00	39,50	58,0	9,0	8	4 x 2	
M0104	66,5/68,0	46,0	17,00	30,00	62,0	7,8	6		
M0105	84,0	58,0	22,20	38,50	78,0	8,0	8	5 x 2,5	
M0106	66,0	45,0	17,00	29,50	59,5	7,2	6		
M0107	62,8/67,0	45,0	17,00	29,50	62,8	7,0	6		
M0108	65,0	44,0	17,00	26,50	59,5	8,0	5		
M0109	54,5/57,0	39,5	17,00	25,50	54,5	3,2	6		
M0110	70,0	48,0	17,00	21,00	64,5	5,6	4		
M0111	61,0	42,0	17,00	37,50	56,0	15,5	6		
M0112	55,0	33,5	17,00	44,50	50,0	22,5	6		
M0113	62,5/64,5	42,0	17,00	35,00	57,5	13,0	6		
M0114	61,0/62,0	40,0	17,00	35,00	55,0	13,4	6		
M0115	60,0	39,0	17,00	28,50	55,0	17,0	3		
M0116	65,0	44,0	17,00	35,00	60,0	6,0	8		
M0117	66,5	49,0	17,00	29,00	66,5	4,4	7		
M0118	72,0	38,5	17,00	44,00	66,7	14,0	8		
M0119	55,0	36,0	17,00	27,50	49,0	5,5	6		
M0120	55,0	36,0	17,00	41,00	49,0	18,5	6		
M0121	59,0/62,5	45,0	17,00	27,50	57,0	5,0	6		
M0122	60,0	41,0	17,00	39,00	54,5	16,6	6		
M0123	56,0/58,5	41,0	17,00	26,00	56,0	3,0	6		
M0124	54,5/57,0	40,0	17,00	25,50	54,5	3,2	6		
M0125R	58,5/76,0	42,0	17,00	40,00	55,0	18,5	6		
M0126	83,5	65,0	17,00	37,00	76,8	4,2	9		
M0127	92,0	63,0	30,00	35,50	86,5	6,0	8	8 x 4	
M0128	63,5	45,0	17,00	41,50	57,5	12,0	8		
M0129	72,0	50,0	17,00	34,00	70,0	4,5	8		
M0130	77,5	58,0	17,00	37,50	70,0	8,0	8		
M0131	80,0/84,0	60,0	17,00	42,00	77,0	9,0	9		
M0132R	58,5/76,0	42,0	17,00	40,50	55,0	18,5	5		
M0133	48,8	36,0	17,00	31,00	48,8	10,0	6		
M0134	91,0	66,5	30,00	35,50	86,5	5,5	8	8 x 4	
M0135	68,0	43,0	17,00	39,00	61,5	20,0	5		
M0136	55,0	35,0	17,00	43,30	50,0	20,5	6		Alt. fondo: 8,5mm
M0136R	55,0	35,0	17,00	43,30	50,0	20,5	6		Alt. fondo: 19mm
M0137	85,5	51,0	17,00	36,50	80,5	6,0	8		
M0138	66,0	45,0	17,00	39,50	59,5	24,0	4		
M0139	96,5	74,0	30,00	40,00	89,5	6,0	9	8 x 3	
M0140	60,0	38,0	17,00	42,50	55,0	19,5	6		
M0141	74,5	47,0	17,00	42,00	68,0	20,0	6		
M0142	55,0	34,5	17,00	43,50	50,0	14,0	8		
M0143	55,0	36,0	17,00	38,00	49,5	18,0	5		
M0144	58,5	36,0	17,00	30,50	52,5	8,5	6		
M0145	55,0	36,0	17,00	28,50	49,5	5,5	6		

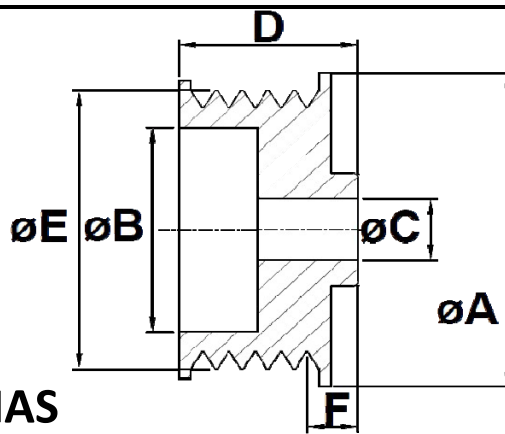

## MEDIDAS DE POLEAS MULTIVIAS

Código	Ø A	Ø B	Ø C	D	E	F	Vias	Chavetero	Obs.
M0146	59,0/60,0	40,0	17,00	24,50	54,0	9,0	4		
M0147	61,5	41,0	17,00	38,00	55,0	11,0	7		
M0148	59,0/54,0	38,5	17,00	24,00	54,0	6,0	5		
M0149	59,0	40,0	17,00	33,50	55,5	11,0	6		
M0150	58,0/60,0	40,0	17,00	29,50	53,0	11,0	5		
M0151	59,0	36,0	17,00	29,50	54,5	10,5	5		
M0152	53,0	36,0	17,00	30,50	49,0	8,0	6		
M0153	73,0	54,1	17,00	49,00	69,0	5,0	12		
M0154	60,0	46,0	17,00	28,50	60,0	17,5	3		
M0155	55,0	36,0	17,00	31,50	49,5	8,0	6		
M0156	60,0	41,0	17,00	34,00	55,0	11,0	6		
M0157	58,5/60,5	37,0	17,00	39,50	53,0	20,0	5		
M0158	60,0	40,0	17,00	26,00	54,5	4,5	6		
M0159	59,0/63,0	42,0	17,00	42,00	59,0	23,0	5	4 x 2	
M0160	49,0/54,0	36,0	17,00	29,50	49,0	7,0	6		
M0161	78,5	56,0	17,00	29,00	72,0	5,5	6		
M0162	61,0	41,0	17,00	35,00	55,0	8,0	7		
M0163	60,0/60,5	41,0	17,00	35,5	54,5	12,0	6		
M0164	60,0	38,0	17,00	42,5	55,0	19,5	6		Alt. fondo: 8mm
M0165	54,0	41,0	17,00	31,5	54,0	10,5	6		
M0166	57,0	40,0	17,00	30,5	52,5	8,5	6		
M0167	58,5/60,0	40,0	17,00	28,5	53,0	9,0	5		
M0168	52,0/55,0	38,5	17,00	30,0	49,0	8,0	6		
M0169	47,5	37,0	17,00	21,5	47,5	2,5	5		
M0170	90,5	68,0	17,00	43,0	85,0	12,5	8		
M0171	54,0/59,0	37,0	17,00	25,5	54,0	6,5	5		
M0172	64,0	40,5	17,00	36,5	58,0	6,5	8	4 x 2	
M0173	72,0	48,0	17,00	46,0	67,5	23,5	6		
M0174	65,0	42,5	17,00	34,5	59,5	15,0	5		
M0175	58,0	36,5	17,00	24,0	52,0	8,5	4		
M0176	85,5	49,0	22,20	53,5	80,0	24,5	8		
M0177	64,0	33,0	17,00	20,0	60,0	6,0	4	3 x 1,5	
M0178	52,0/55,0	38,0	17,00	42,5	51,0	24,0	5		
M0179	64,5	46,0	17,00	39,0	60,0	9,0	8	4 x 2	
M0180	76,5	53,0	17,00	32,0	70,5	9,0	6		
M0181	59,0 / 62,0	42,0	17,00	28,0	57,0	4,5	6		
M0182	70,5	38,0	17,00	31,5	65,5	9,0	6		
M0183	73,0	40,0	22,20	55,5	65,0	10,5	12		
M0184	72,0	50,0	17,00	40,0	72,0	7,5	8		
M0185	76,0	51,0	17,00	34,0	70,0	4,5	8		
M0186	64,5	45,0	17,00	35,0	57,5	5,5	8		
M0187	54,0	36,0	17,00	31,0	48,0	5,0	7		
M0188	58,5	37,0	17,00	34,0	52,5	8,0	7		
M0189	54,0	34,5	17,00	39,0	47,0	9,0	8		
M0190	65,0/65,5	43,0	17,00	25,5	60,0	9,5	4	3 x 2	
M0191	84,0	56,5	22,20	38,5	78,5	8,5	8	5 x 2,5	Próx. Lanzamiento
M0192	75,0	49,0	17,00	35,5	70,5	5,5	8		
M0193	62,0/65,0	45,0	17,00	29,0	62,0	7,0	6		